

# Direction to Interdisciplinary Graduate School (IGS) Office

## By MRT

- Take the MRT to Pioneer station and take the free shuttle service along “**red line**” (i.e Nanyang Avenue). The frequency is 15mins
- Alight at *Tan Chin Tuan Lecture Theatre* and walk down slope along “**green line**” towards Car Park B (sheltered car park) at South Spine.
- Walk towards Lift Lobby SS2 and see entrance door to SCHOOL OF ELECTRICAL AND ELECTRONIC ENGINEERING
- Enter via entrance door of SCHOOL OF ELECTRICAL AND ELECTRONIC ENGINEERING and you’ll see INTERDISCIPLINARY GRADUATE SCHOOL (IGS)
- Press the doorbell or call 6592 3077

## By Motor

- Exit 38 at PIE
- Follow the “**blue line**” (i.e along Nanyang Drive) to Car Park B (sheltered car park) at South Spine.
- Stop near Lift Lobby SS2 and see entrance door to SCHOOL OF ELECTRICAL AND ELECTRONIC ENGINEERING
- Enter via entrance door to SCHOOL OF ELECTRICAL AND ELECTRONIC ENGINEERING and you’ll see INTERDISCIPLINARY GRADUATE SCHOOL (IGS)
- Press the doorbell or call 6592 3077

## Interdisciplinary Graduate School (IGS)

50 Nanyang Avenue, South Spine, Level B3, Block S2-B3a-01, Singapore 639798

[Diagonally opposite the NTU computer shop – 8 Flags (same level)]

Tel: 6592 3077

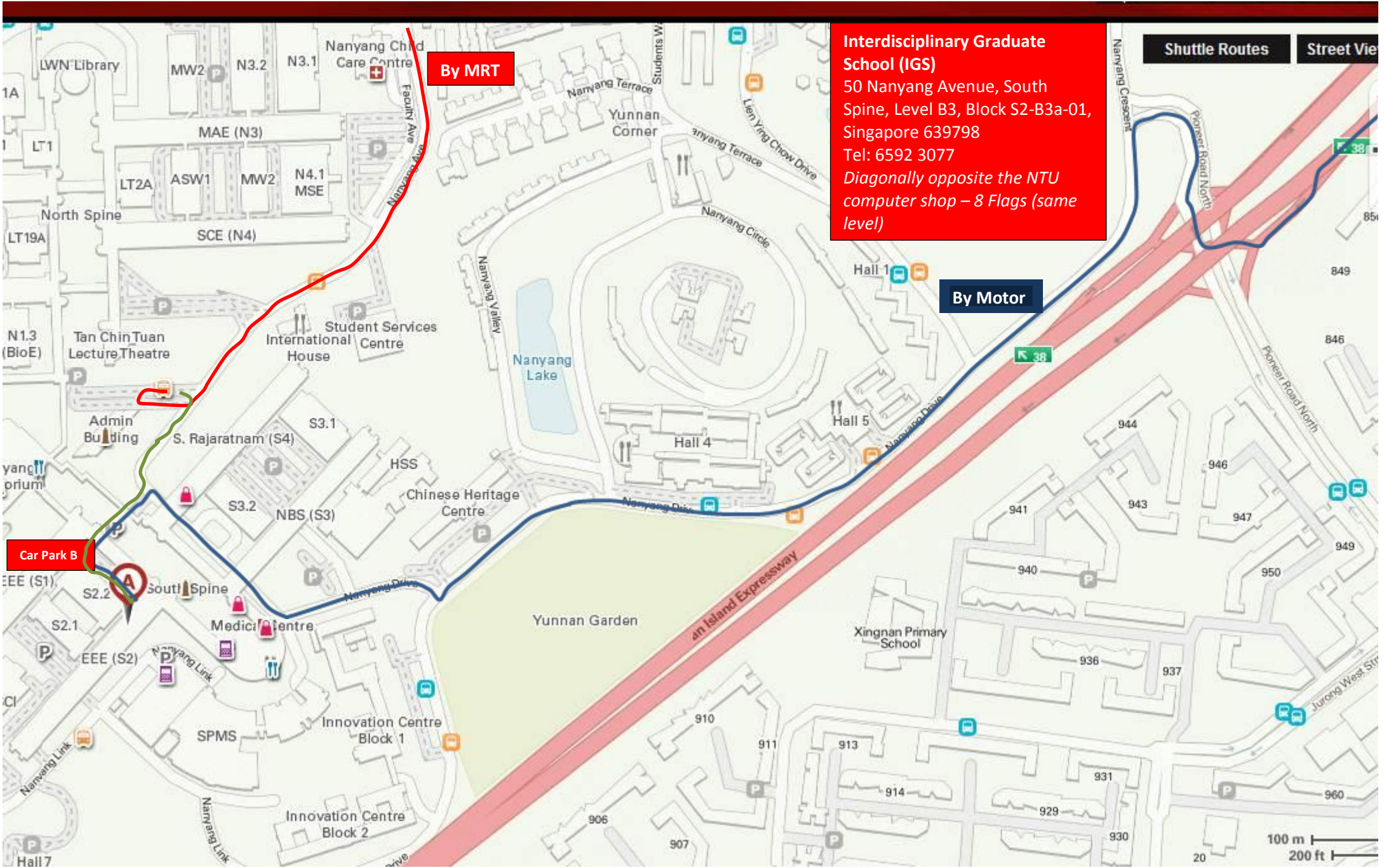

**By MRT**

**Interdisciplinary Graduate School (IGS)**  
50 Nanyang Avenue, South Spine, Level B3, Block S2-B3a-01, Singapore 639798  
Tel: 6592 3077  
*Diagonally opposite the NTU computer shop – 8 Flags (same level)*

**By Motor**

**Car Park B**

**Shuttle Routes** **Street View**

100 m | 200 ft |